

Greenmood

MANUAL INSTALLATION

FRAMED

1. INSTALLATION MANUAL



1. INSTALLATION MANUAL (1/1)

FRAMED

WALL MOUNTING (2-4 fixing points)

Materials needed:



Pencil



Screws &
dowels

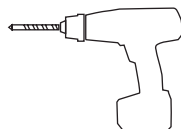

Hand drilling
machine



Measuring tape
or laser



Profesional spirit
level or leveling
alignement
lasser

1. Choose a vertical or horizontal format for your frame installation
2. Measure the distance between the center points of the holes
3. Mark two holes aligned at the same level
4. Use a driller to make the holes on the wall
5. Introduce the screws into the dowels
6. Mount the frame using the holes eyelets integrated in the frames backface.

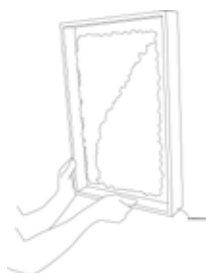

1



2



3



4

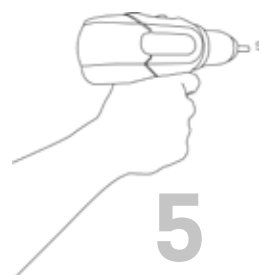

5

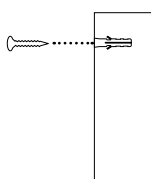

6



7